

12-13 Rosemary Court Mulgrave Victoria Australia 3170
 telephone: (03) 8562 0888 facsimile: (03) 8562 0899
 email: sales@fethers.com web: www.fethers.com

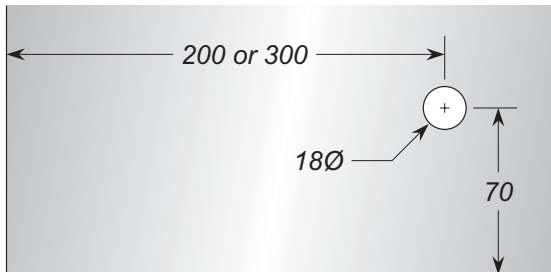

Product Code

FMP 250

Product Type

**Stainless Steel
Mini Post**

Available Finishes

- 316 Satin Stainless Steel
- 316 Polished Stainless Steel

Technical Details

- Suitable for 12mm and 15mm glass
- 250mm high
- 50mm diameter

See opposite for maximum panel sizes.

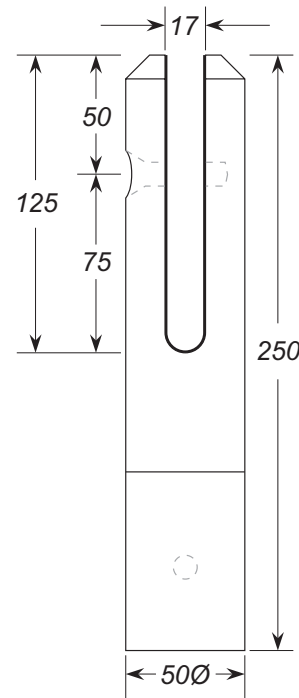

Installation Instructions

- Step 1.** Determine appropriate glass sizes by referencing the Pool Fence Guide on the following page or referring to a suitably qualified engineer for use in Balustrades.
- Step 2.** Core drill concrete to 63mm diameter, 110mm deep.
- Step 3.** Remove rubber gasket from mini post and locate on glass.
- Step 4.** Spray rubber gasket with soapy water and tap Mini Post into position on the glass panel.
- Step 5.** Tighten M10 CSK Bolt through Mini Post.
- Step 6.** Repeat for other posts on panel.
- Step 7.** Stand glass panel with mini posts attached into core drilled holes.
- Step 8.** Plumb and position panels and pour a suitable epoxy resin (suggest Sikadur-52) around post and allow to cure. Ensure panels are braced until epoxy completely cured.